

G80 MESH HOOK

SPECIFICATION FOR 2500KG WORKING LOAD LIMIT



G80 MESH HOOK

Engineered for efficiency and safety, the Austlift Mesh Hook G80 is the ideal solution for fast and secure lifting of steel mesh. With a Working Load Limit of 2500KG, this hook is crafted from Grade 80 high-strength alloy steel and undergoes rigorous batch testing to ensure top-tier reliability on site.

- Marked with size, designation, grade, manufacture quality mark and Austlift branded.
- Batch tested, test certificates available upon request.
- Product ensures a 4:1 safety factor
- Fatigue tested > 20,000 times.

Application

- Building construction sites
- Ship building yards
- Crane production sites
- Mine production sites
- Engineering Workshops

AS
3776

Certified

Safety Factor
4-1

G80
Alloy Steel

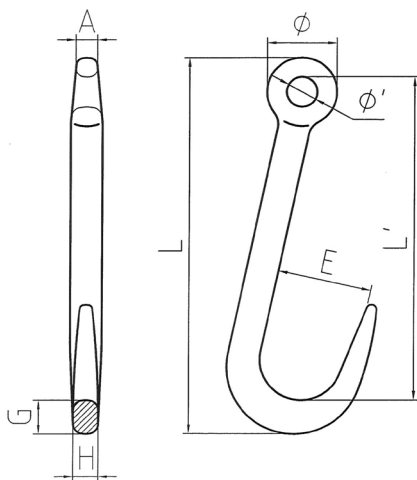

Item Code	Weight (KG)	WLL (T)	BF (T)	A	E	G	H	Ø	Ø'	L	L'
104525	1.57	2.5	10	16.8±1	74.5±2	27±1	20±1	55±1	24±1	302±3	256.5±3